

ArcGIS 10.1 Install Instructions; Valid and Checked 2013/2014

Insert ArcGIS Desktop DVD and let it autorun; if it doesn't autorun when you insert the DVD then browse to the DVD and double click ESRI (capital letters) to launch setup.

In: Initial Setup Menu

- Select **SETUP** next to ArcGIS Desktop

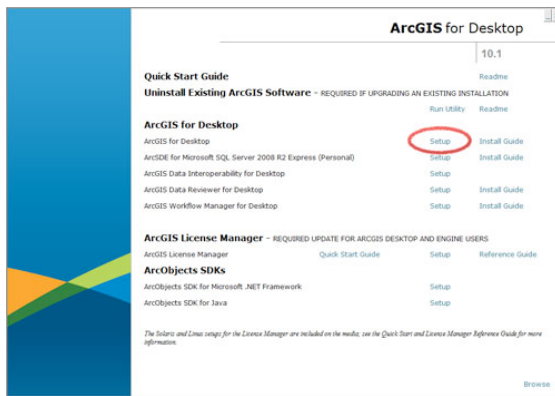

In: ArcGIS Desktop 10 Setup

- [Next]
- Accept Licence [Next]
- Select Complete Setup [Next]
- Allow Python install [Next] [Next] [Next]

Application install now takes place - this can take quite a long time [Finish]

You will then be taken straight into the Administrator Wizard – CANCEL this; later there is an updated version you need to install and configure instead.

- Select **SETUP** next to Data Interoperability for Desktop

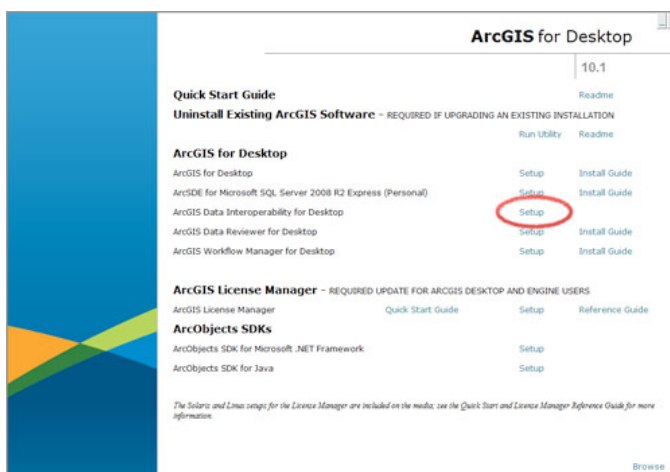

In: ArcGIS 10.1 Data Interoperability for Desktop Setup

- [Next]
- Accept Licence [Next]

- [Next]
- [Next]

Application install now takes place – this is a few minutes [Finish]

Now install the updated licence manager

- Select SETUP next to ArcGIS Licence Manager

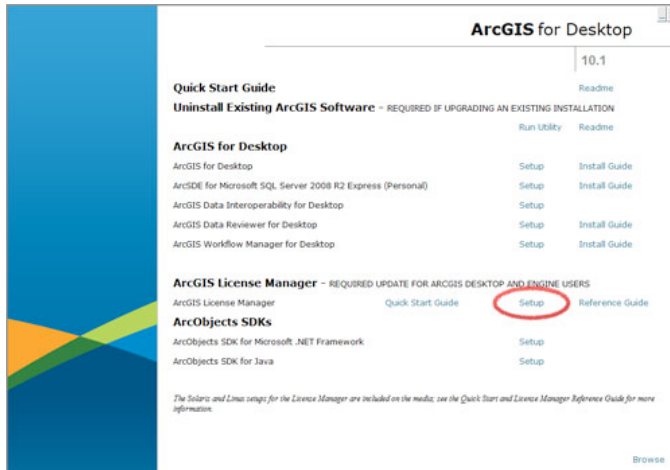

In: ArcGIS Licence Manager Administrator Wizard

- [Next]
- Accept Licence [Next]
- [Next]
- [Next]

Application install now takes place – this doesn't take long [Finish]

You can now close the ArcGIS for Desktop Setup Window and run the standalone licencing application

- Start – All Programs – ArcGIS – ArcGIS Administrator

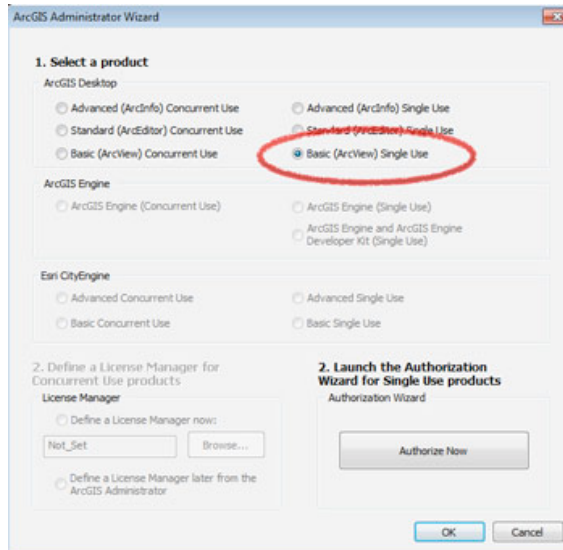

- Choose Basic (ArcView) Single Use
- Authorise Now
- I have installed my software and need to authorise it [Next]
- Authorise with ESRI now using the Internet [Next]
- Fill in the rather tedious Authorisation Information form [Next]
- Your organisation, industry [Next]
- Enter serial code for ArcGIS for Desktop Basic: **[this will be on the code form ending 095]** [Next]
- *You need additionally to authorise individual extensions:*

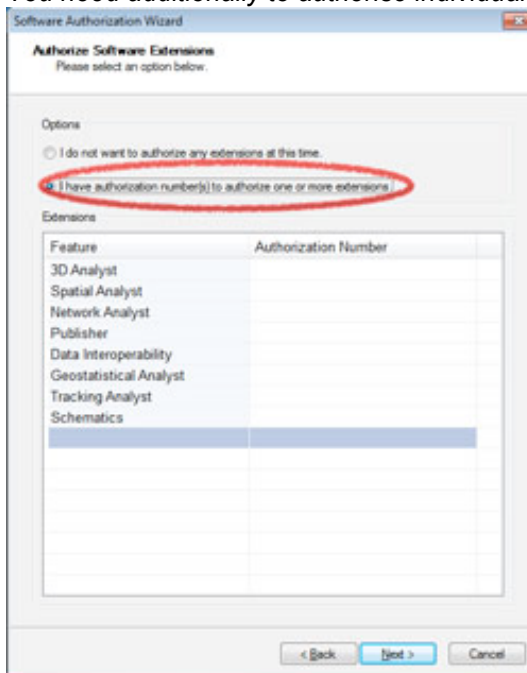

I have authorisation numbers for one or more extensions

- Enter ESU serial codes **using the codes from the library** for these extensions:
 - 3D Analyst
 - Spatial Analyst
 - Network Analyst
 - Publisher
 - Data Interoperability
 - Geostatistical Analyst
 - Tracking Analyst
 - Schematics

- [Next] [Next] [OK]

Authorisation now takes place across the Internet; takes a minute or two as each extension serial code is validated [Finish]

Install in now complete; Launch ArcGIS

Windows Start – All Programs – ArcGIS – ArcMap 10.1

The additional extensions are enabled by selecting Customize – Extensions